

# SHROPSHIRE FIRE AND RESCUE SERVICE

## FIRE SAFETY ADVICE SHEET

### EMERGENCY ESCAPE SIGNAGE

#### **Introduction**

Emergency escape signs must be used (where necessary) to help people identify escape routes/exits. In simple premises with only one way in and out, the provision of such signage is unnecessary. However, in larger more complex premises, a series of signs directing people along escape routes to final exits may be needed.

The number and positioning of emergency escape signage should be determined by the fire risk assessment required to be carried out under the Regulatory Reform (Fire Safety) Order 2005 and must comply with the provisions of the Health and Safety (Safety Signs and Signals) Regulations 1996. For a sign to comply with the Regulations it must be pictographic. Examples of suitable signage are given below.

The pictogram can be supplemented by text if considered necessary to make the sign easily understood, however, signs using text only should not be used. Either type of sign; pictograms or pictograms with text may be used but the two should not be mixed

The legibility of escape signs is determined by the size of the sign, its level of illumination and the distance over which it is viewed. The use of signs within the same premises should follow a consistent design pattern.

The presence of other signs such as advertising or customer information can distract attention from, or obscure the visibility of escape signs. Always ensure that escape signs are not overwhelmed. Similarly, care should be taken to ensure escape signs are not 'disguised' by customer signs using the same colouring.

In multi-occupied premises, co-operation between the respective responsible persons including, if necessary, the managing agents or landlord should be sought to ensure that, as far as possible, all signs in the building conform to a single pattern.

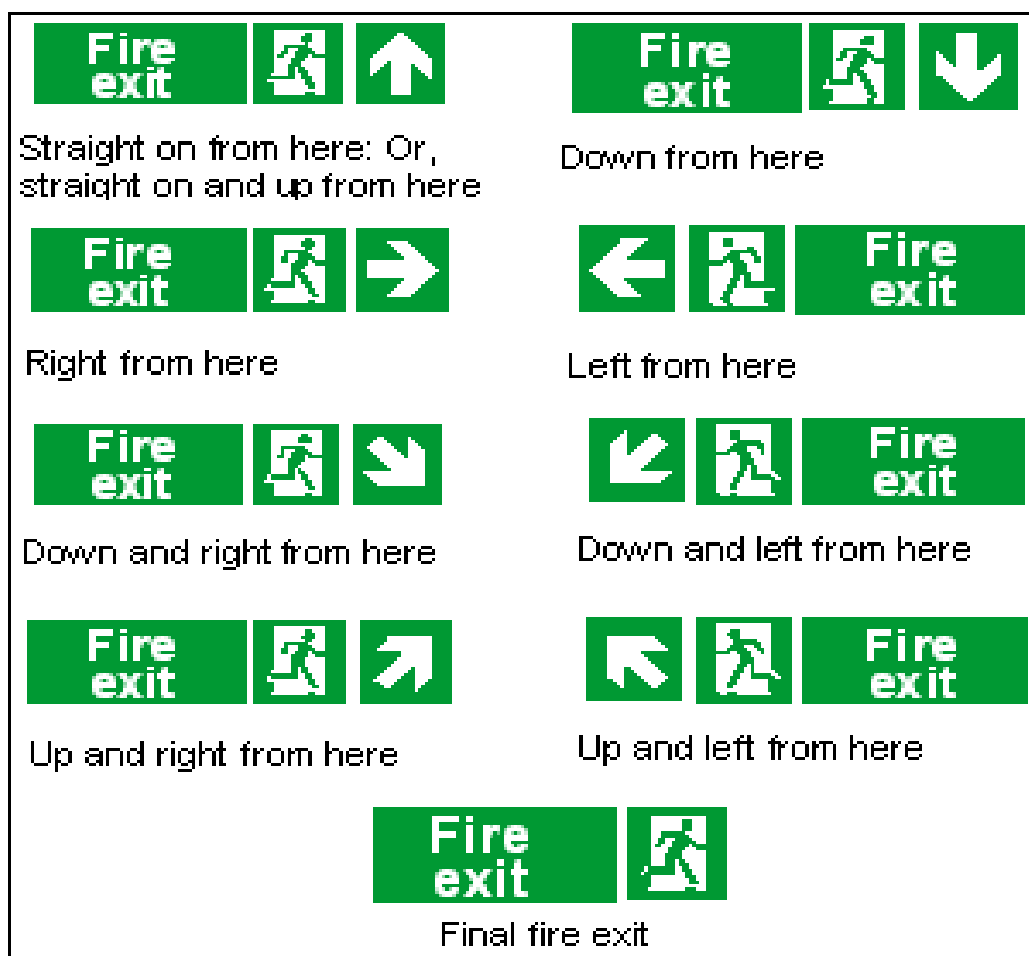

### Positioning of Escape Signs

Escape signs should meet the following criteria:-

- They should provide clear, unambiguous information to enable people to safely leave a building in an emergency
- Every escape route sign should, where necessary, incorporate, or be accompanied by a directional arrow. Arrows should not be used on their own.
- If the escape route to the nearest exit is not obvious then it should be indicated by signage
- Signs should be positioned so that a person escaping will always have the next escape route sign in sight

- Signs should not be fixed to doors as they will not be visible if the door is open. Signs should be mounted above doors at a height of between 2.0m and 2.5m above the floor
- Signs on walls should be mounted between 1.7m and 2.0m above the floor
- Hanging signs in large open spaces may be mounted at a height greater than 2.5m but care should be taken to ensure such signs are conspicuous and legible. In such cases larger signs may be necessary
- As far as is reasonably practicable, signs should be mounted at a uniform height throughout the escape route.

For further information on the Regulatory Reform (Fire Safety) Order 2005 please contact:

- Department for Communities and Local government - <http://www.communities.gov.uk>
- Shropshire Fire and Rescue Service - [www.shropshirefire.gov.uk](http://www.shropshirefire.gov.uk)

Or for general fire safety matters, Shropshire Fire and Rescue Service can be reached on **01743 260260** or via our web site at **[www.shropshirefire.gov.uk](http://www.shropshirefire.gov.uk)**