

# ALUMAGUARD EE



## INSTALLATION RECOMMENDATIONS

Ducts **must** be sealed in accordance with **SMACNA HVAC Duct Construction Standards Metal and Flexible - Second Edition (1995) Seal Class A** prior to insulation of ALUMAGUARD.

The introduction of **ALUMAGUARD LITE**, makes it unnecessary to pin through the membrane on the bottom of duct. The weight and construction of ALUMAGUARD LITE does not require mechanical support.

Hot and cold air ducts should be installed in the following manner to maintain proper vapor barrier and physical integrity; the board insulation should be mechanically installed on properly sealed duct according to the engineer's specification using insulation fasteners (mini-cup weld pins or perf. based pins and washers). Insulation on the top of the ductwork *should* be installed in such a manner as to allow for 'water shed' from the top of the duct to prevent water from 'ponding'.

Polyguard recommends faced rigid foam insulation (closed cell) for a smooth look, less seams, and superior R-Value per inch. Extruded polyisocyanurate and expanded polystyrene with a foil or polyethylene face.

Polyguard recommends our ALUMAGUARD EE system be installed according to one of the following procedures;

- Cut one piece of ALUMAGUARD LITE to cover the underside of the duct and up 6" on each side. **DUE TO THE POTENTIAL ABUSE POLYGUARD DOES NOT RECOMMEND THE APPLICATION OF ALUMAGUARD LITE TO THE ENTIRE DUCT, USE ALUMAGUARD, ALUMAGUARD EE, OR ALUMAGUARD LT ON THE TOP AND SIDES.**
- Cut two side pieces to fit from the bottom corner of the duct up over the top of the duct, lap over the top 6", **DO NOT FOLD A LAP UNDER THE DUCT.**
- Cut the final piece to cover the top, trim it flush with the top corners. Roll the ALUMAGUARD EE membrane as you remove the release film with a laminate roller to insure adhesion and lessen wrinkling, be careful of the asphalt strip when installing it., don't let it fold under and stick to the backing.

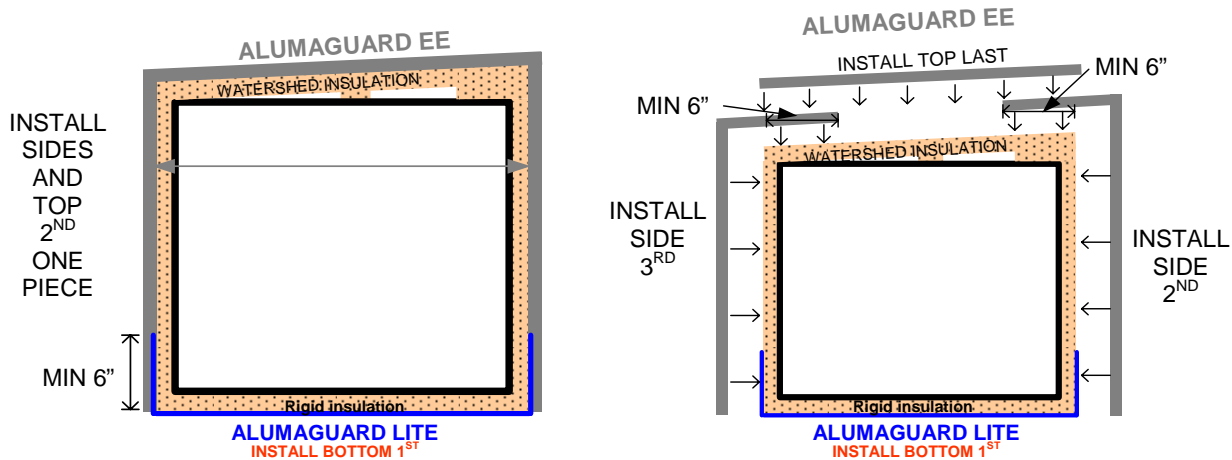

ALUMAGUARD EE can also be installed in a one piece application when duct size permits. Starting at the bottom of one side of the duct, go up the side, over the top, and down the other side trimming the Alumaguard flush with the bottom corner of the duct; **do not terminate the lap on the bottom of the duct!**

ALUMAGUARD EE must be protected from damaging chemicals; being rubberized bitumen, we will be 'solvated' when exposed to petroleum or coal tar based compounds. If you are unsure of the materials you will be subjecting our product to, please feel free to call us at 1-800-541-4994 for more information. Store ALUMAGUARD EE in a warm dry place prior to installation. For specific installation recommendations please call us for detail drawings as you require them.



**Polyguard**  
[www.polyguardproducts.com](http://www.polyguardproducts.com)





ALUMAGUARD EE is an excellent cold piping jacketing system; superior to metal or PVC in performance. It's properties facilitate installation on cold systems ***WITHOUT*** the need for slip joints, eliminating a potential vapor breach. ALUMAGUARD EE will expand and contract with the piping system without rupture; minimal wrinkling may occur.

**NOTE: ALUMAGUARD EE IS NOT TO BE USED AS A MECHANICAL FASTENER!** Insulation must be installed (tape or bands) according to the manufacturers instruction. ***DO NOT PAINT ANY ALUMAGUARD PRODUCT BEFORE READING OUR TECHNICAL BULLETIN SHEET, it can void your warranty!***

Installation is performed in a cigarette wrap method using a 3" longitudinal lap and a 6" circumferential lap. Cold piping systems jacketed with ALUMAGUARD EE should be installed in the following manner; the "stretch out" for each piece should be cut to allow a 6" lap over the circumference of the insulation. Install tightly around the pipe insulation so that your termination lap is faced down for watershed, rolling with a laminate roller or other firm "rolling pin" type roller to insure contact with the substrate. Install the first piece with the extended edge toward your continued work surface, handle the extended edge carefully when removing the release liner, as it does not have much support from the zip strip, seal the piece and remove the zip strip from the extended edge, making sure to rub down the asphalt edge prior to removing the zip strip. Each subsequent piece should install 3" over the previous piece so that you get an asphalt to asphalt seal under the lap. **YOU WILL NOT BE ABLE TO GET THE ASPHALT TO ASPHALT SEAM APART, SO BE CAREFUL WHEN YOU PLACE THE SECOND PIECE OVER THE FIRST!** ALUMAGUARD EE is not a mechanical fastener, insulation should be installed with strapping or banding according to manufacturers instruction. Alumaguard EE cannot be pre-applied to pipe insulation.

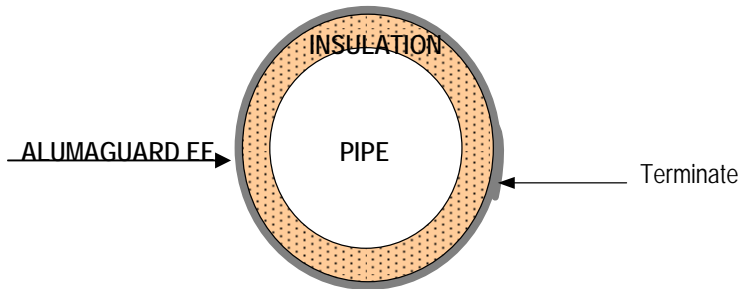

**NOTE:** Care should be taken when using any ALUMAGUARD product on a hot system, insure that the surface temperatures after insulation do not exceed our upper use limitations. It is important to note that heat transfer through single layer joint seams could result in the softening or melting of the rubberized asphalt compound.

Insulated piping exceeding 12" outside diameter requires the use of banding on Alumaguard EE.

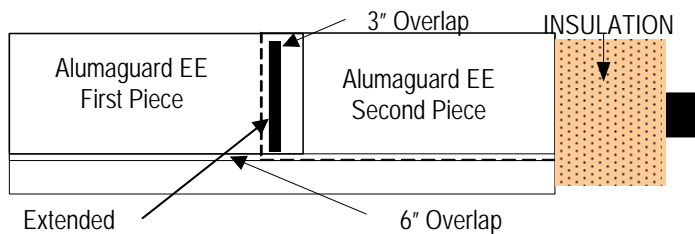

Fittings, 90's, tees, valves, and 45's can be laid out using standard sheet metal methods, modified to allow for overlap, you would not use the extended edge portion for fittings. This can be accomplished by adding to the throat and heel of the fittings. The bottom piece is installed first, and then the top piece lapped over the bottom piece to permit water shedding over the lap. Tees, valves and other fittings can be fabricated just like you would use standard layout procedures, either two piece or gored fittings, simple add for the overlap. Fittings can also be 'gored', over sizing each gore piece to allow for a lap onto the preceding piece. Installers can also use standard metal fitting covers with the Alumaguard products. Care must be used to insure that the fittings are vapor sealed!

REV 4.3.07